

产品特性/Product Features

- IP6K9K
- 600A 85°C长时间载流能力
- 12-750VDC
- 1000MΩ (1000VDC) , IEC60664-1
- PCB

触点参数 / Contact parameters

	1a
	≤0.5mΩ (at 600A)
	600A
	2×10 ⁶
	1000VDC
	3000A(320VDC)1
	600kW
1)	5×10 ⁴ 750VDC, 120A, 0.6s :5.4s
	1×10 ⁵ 800VDC,10A
	1×10 ⁵ 800VDC,100A
	2×10 ⁵ 750VDC,300A
	500 750VDC,600A
	5×10 ⁵ 750VDC,-100A
	1×10 ⁶ 750VDC,-300A
	300 750VDC,-600A
	1 800VDC,2500A
	100 1000VDC,600A
2)	600A:
	800A:20min
	1000A:5min
	3000A:4s
	8000A:10ms

1) 23°C, 0.05s:20s,

2) 85°C, 200 mm²,
3) 8000A 10ms

安装孔尺寸 / 接线图 Mounting hole size/Wiring diagram

Mounting hole size

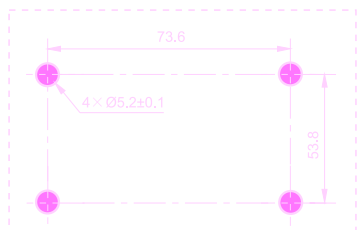

Wiring diagram

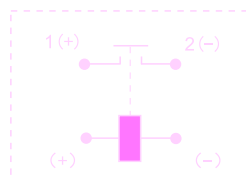

1

线圈引出形式 Coil take-up form

Electrical life curve

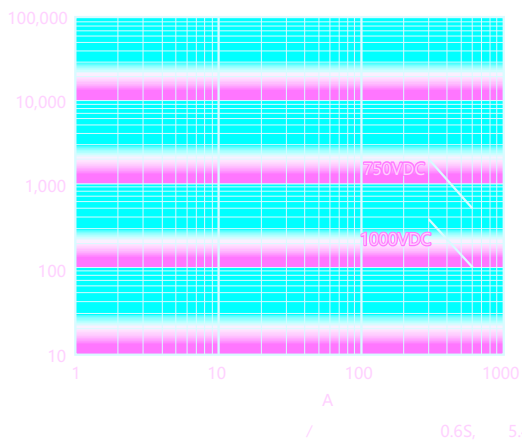

Tolerance curve

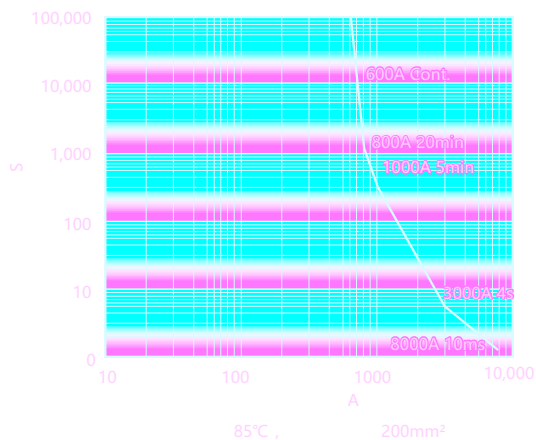

使用注意事项 Precautions for use

1. 安装孔尺寸: M5, 20N·m~25N·m, 3N·m~4N·m

M10	20N·m~25N·m	Ø10~Ø10.5mm	≥6mm	M5螺钉	3N·m~4N·m
-----	-------------	-------------	------	------	-----------

2. 线圈引出形式: 200mm²
3. 电气寿命: 0.2s, 0.2s
4. 公差曲线: 3000A 1s, 8000A 10ms



声明/Statement:

1.

2.